

**ALLDAY  
& MILLER**



Park Lane, Hayes, UB4 8AE  
£530,000

 4  1  1  C



Park Lane, Hayes, UB4 8AE

**£530,000**

- Four Bedrooms
- Nash Built
- Sought After Location
- Driveway
- Large Rear Garden
- Semi-Detached House
- Kitchen/Diner Extension
- Close To Local Amenities
- Potential To Extend STPP
- Double Garage

## Description

This property on offer presented in clean and tidy condition throughout comprises of a welcoming entrance hall, spacious reception/through lounge and a fitted kitchen in the rear extension provides access to the large rear garden.

Rising to the first floor four bedrooms all with ample space for furniture, with the potential to extend up in the loft (stpp).

The front of the accommodation benefits from a large driveway space for off street parking. To the rear boasts a sizeable private garden with a double garage, perfect for extra storage space.

## Situation

Situated on a premier road in North Hayes, Park Lane you is well located within close proximity to the local amenities, transport links and great schools including Hayes Park Primary. The Kingshill Avenue parade is a short distance away offering a wide variety of shops, facilities and restaurants/takeaway's. Bus links are accessible connecting you to surrounding areas such as Uxbridge Town Centre, Southall and Heathrow. Hayes & Harlington Station with the ever popular Elizabeth Line is just short drive way. Parks and green areas are also a great highlight being situated in this location.



## Floor Plans

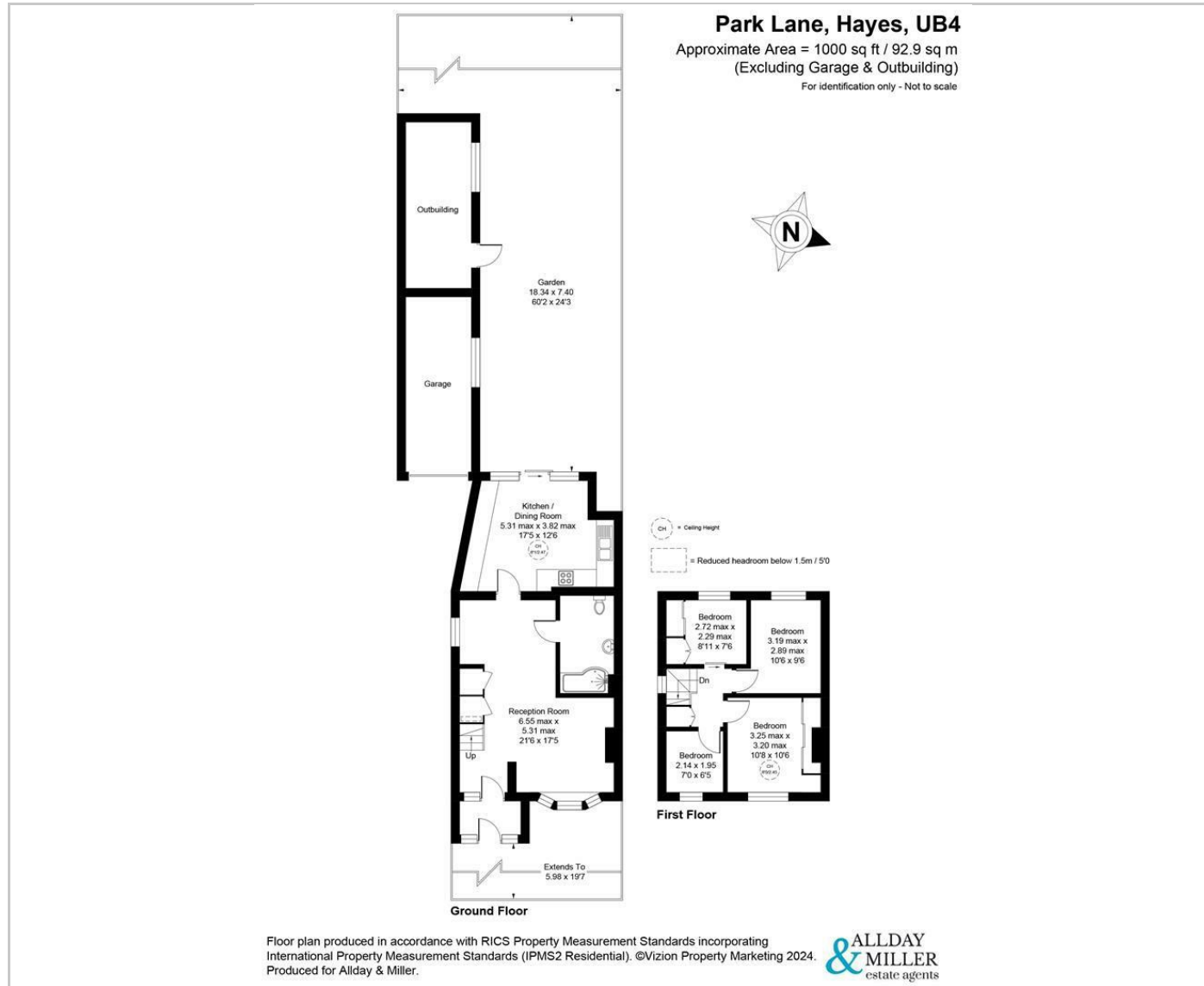

## Area Map

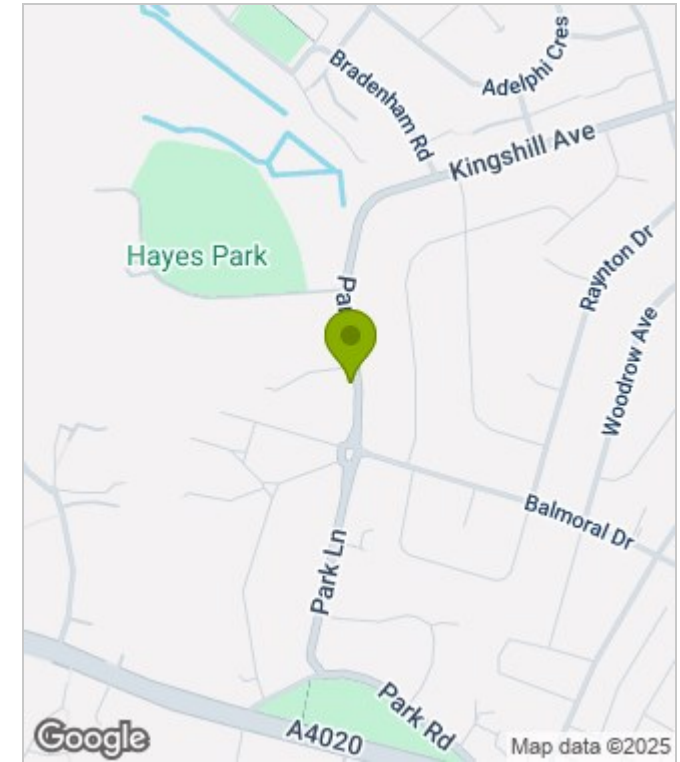

## Energy Performance Graph

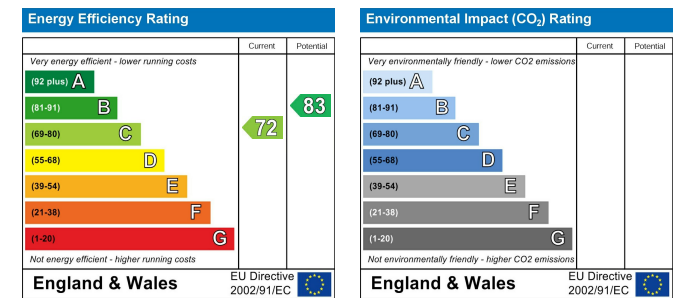

These particulars, whilst believed to be accurate are set out as a general outline only for guidance and do not constitute any part of an offer or contract. Intending purchasers should not rely on them as statements of representation of fact, but must satisfy themselves by inspection or otherwise as to their accuracy. No person in this firm's employment has the authority to make or give any representation or warranty in respect of the property.